

ICS Mill Master Heavy Duty
Bearing Assembly

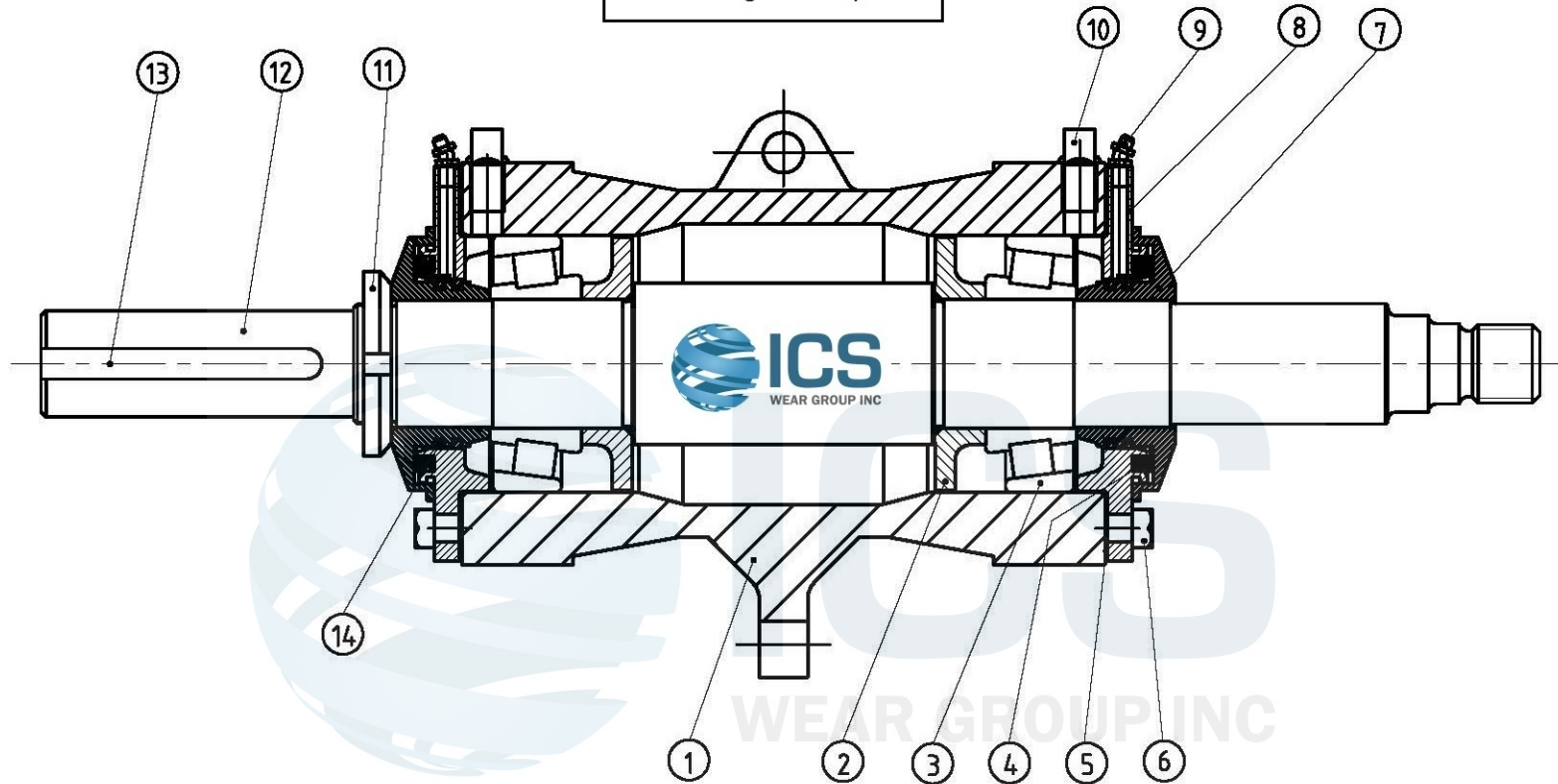

ITEM	Description	Reference	ICS Part Number	Material	QTY
14	Piston Ring	C108HG01	ICSMMCPST	G01/D21	4
13	Shaft Key	C070M	ICSMMCSFK	E02	1
12	Shaft	C073	ICSMMCSFTM	E05	1
11	Laby Locknut	C061	ICSMMCLBL	E62	1
10	Square Plug Screw	1/4"		CS03	3
9	Lubricating Nozzle	45°M6		CS03	2
8	End Cover	C024-10	ICSMMCECV	D81	2
7	Laby Seal	C062-10	ICHMMCLBS	D81	2
6	End Cover Screwset	C027	ICSMMCESC	CS62	8
5	Shim Set	C025	ICSMMCSHM	P10	2
4	Bearing Seal	C089-10	ICSMMBRS	S10	2
3	Bearing	C009	ICSMMCBR	529X/522	2
2	Grease Retainer	C046	ICSMMCGRR	G01/D21	2
1	Bearing Housing	C004M	ICSMMCBH	G01/D21	1

For Pump Size:
ICSHDMMC32 (repl. 3x2 CAH)

** ICS Heavy Duty Bearing Assembly Units (BAU) Can
Be Supplied With Stainless Steel Laby Kit

<p>Bearing Assembly ICSMMCBAU (repl. C005M)</p>	
---	---