

ICS Mill Master Heavy Duty
Bearing Assembly

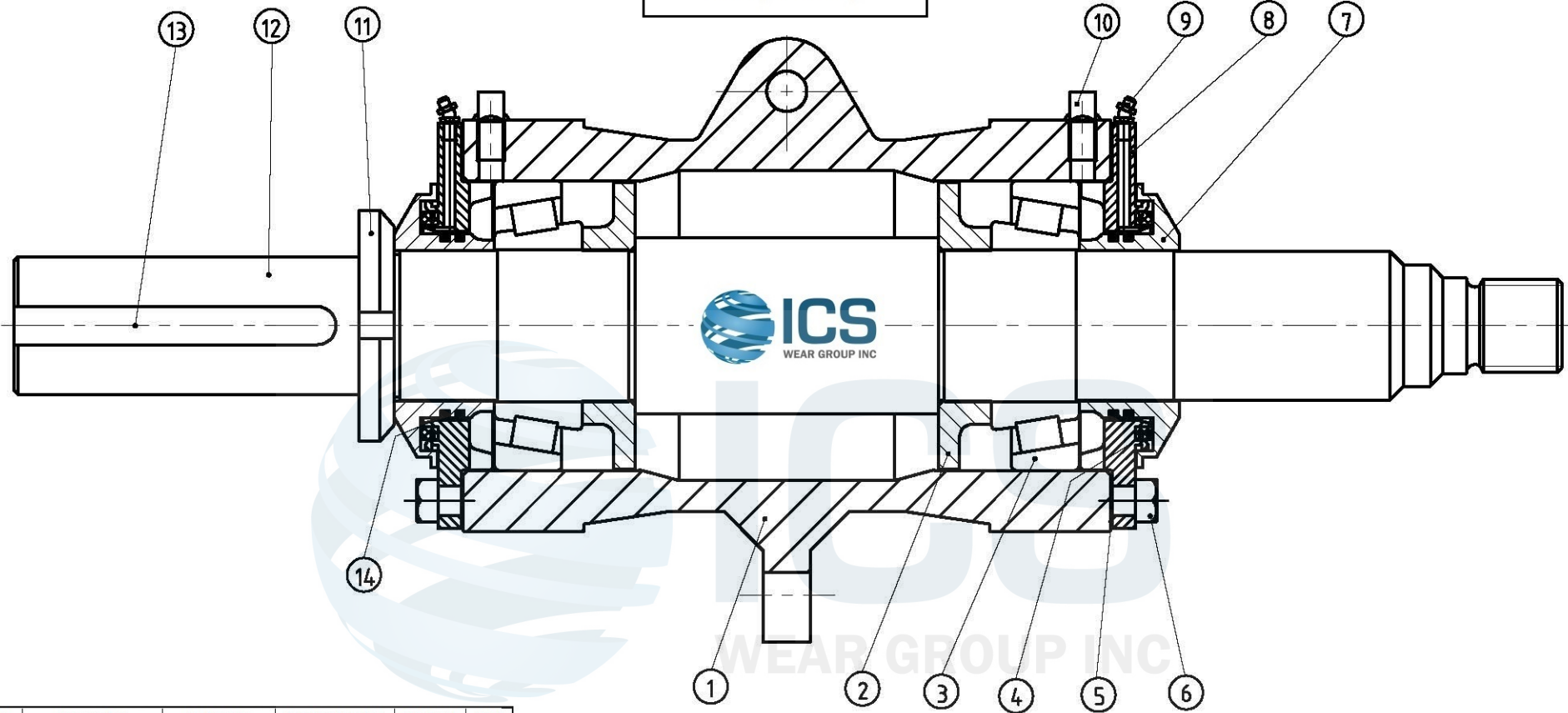

ITEM	Description	Reference	ICS Part Number	Material	QTY
14	Piston Ring	D108HG01	ICSMMDPIST	G01/D21	4
13	Shaft Key	D070M	ICSMMDSFK	E02	1
12	Shaft	D073M	ICSMMDSFTM	E05	1
11	Laby Locknut	D061	ICSMMDLBL	E62	1
10	Square Plug Screw	1/4"		CS03	3
9	Lubricating Nozzle	45°M6		CS03	2
8	End Cover	D024-10	ICSMMDCEV	D81	2
7	Laby Seal	D062-10	ICHMMDLBS	D81	2
6	End Cover Screwset	D027	ICSMMDESC	CS62	8
5	Shim Set	D025	ICSMMDSHM	P10	2
4	Bearing Seal	D089-10	ICSMMDBR	S10	2
3	Bearings	D009	ICSMMDBR	645/632	2
2	Grease Retainer	D046	ICSMMDGRR	G01/D21	2
1	Bearing Housing	D004M	ICSMMDBH	G01/D21	1

For Pump Size:
ICSHDMMMD43 (repl. 4x3 DAH)

** ICS Heavy Duty Bearing Assembly Units (BAU) Can
Be Supplied With Stainless Steel Laby Kit

Bearing Assembly
ICSMMDBAU
(repl D005M)

