

ICS Mill Master Heavy Duty  
Bearing Assembly

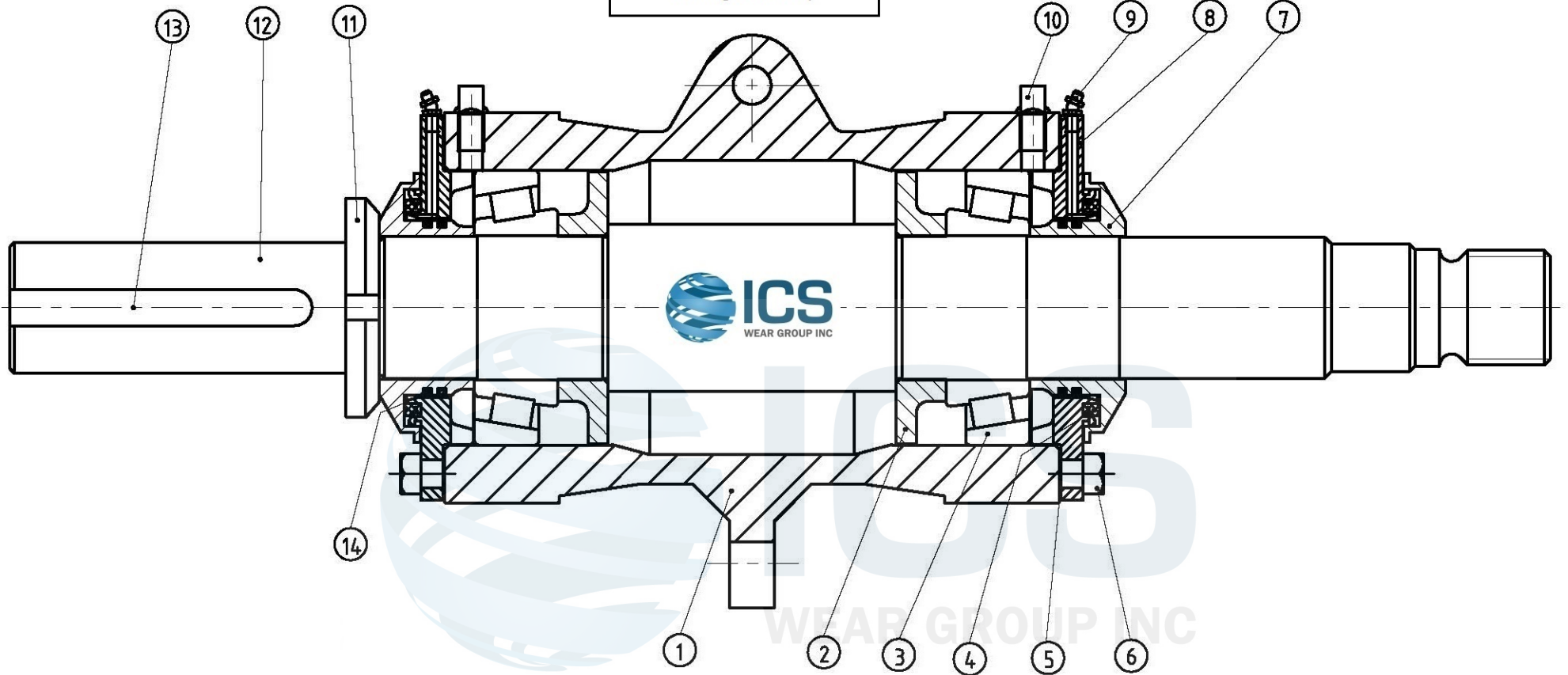

Item	Description	ICS Part Number	Material	QTY
14	Piston Ring	ICSMMDPIST	T200 Grey Iron	4
13	Shaft Key	ICSMMDSFK	Struct Steel	1
12	Shaft	ICSMMDMSFTM	K1045 Steel	1
11	Laby Locknut	ICSMMDLBL	316SS	1
10	Square Plug Screw		CS03	3
9	Lubricating Nozzle		CS03	2
8	End Cover	ICSMMDECV	316SS	2
7	Laby Seal	ICSMMDLBS	316SS	2
6	End Cover Screwset	ICSMMDESC	316SS	8
5	Shim Set	ICSMMDSHM	Polyphenylene Sulphide Ryton	2
4	Bearing Seal	ICMMDDBRS	EPDM	2
3	Bearing	ICSMMDBR	Timken	2
2	Grease Retainer	ICSMMDGRR	Mild Steel	2
1	Bearing Housing	ICSMMDBH	Ductile	1

For Pump Size:  
ICSHDMMMD64 (repl. 6x4 DAH)

\*\* ICS Heavy Duty Bearing Assembly Units (BAU) Can  
Be Supplied With Stainless Steel Laby Kit

Bearing Assembly  
ICSMMDMBAU  
(repl DAM005M)

